

Profile

Fräser N_F 15mm20-34
 Plattendicke mm: 20-34
 1

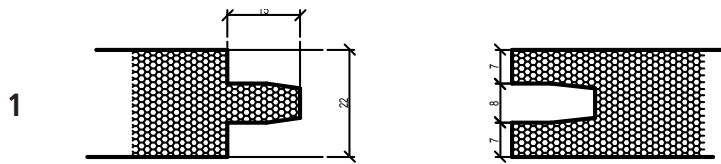

Fräser N_F 25mm35-59
 Plattendicke mm: 35-59
 2

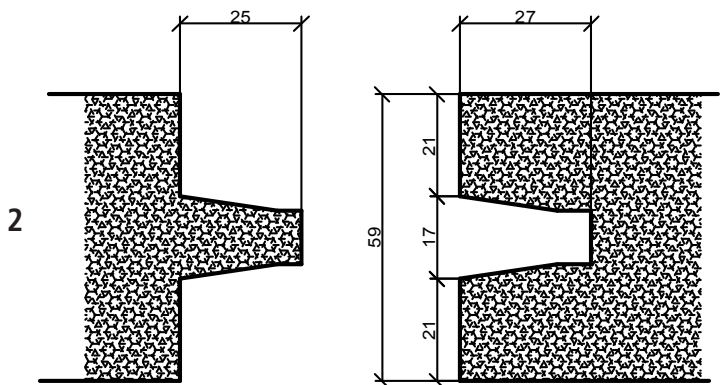
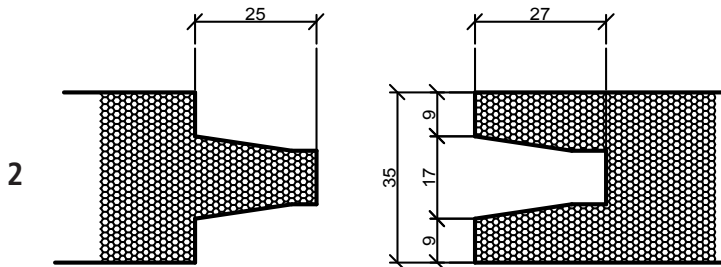

Fräser N_F 25mm60-119
 Plattendicke mm: 60-119
 3

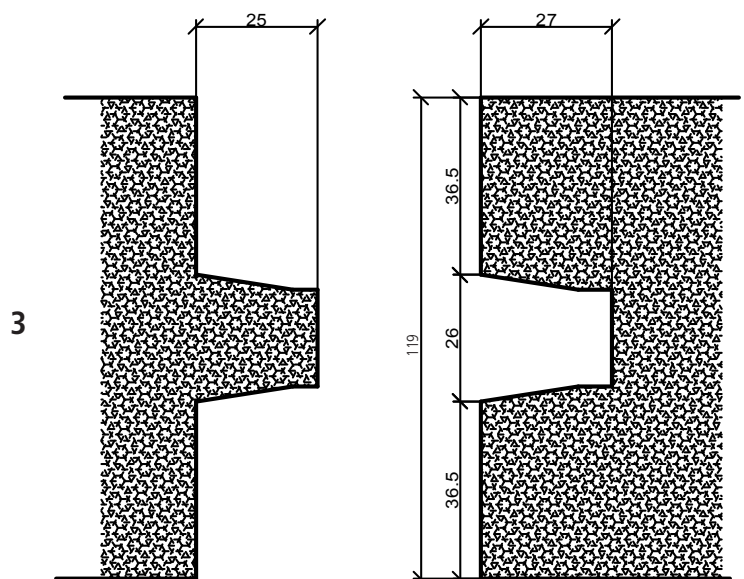
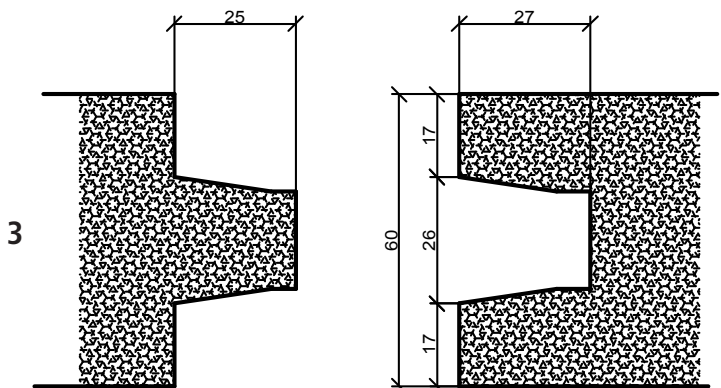

Fräser N_F 25mm120-240
Plattendicke mm: 120-240
4

4

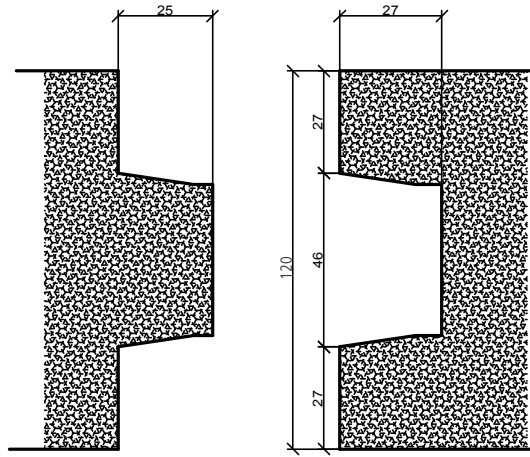

4

