

Lifting systems / Turning system

We can drill the holes for the following lifting systems in the factory.

You can speak to the respective manufacturer about the lifting system itself.

A detailed description of the lifting systems can be found in the Technical information CLT at www.schneider-holz.com/downloads.

Note: The usage instructions of the respective manufacturer (e.g. check drill hole) must be observed before lifting the elements using lifting/turning systems.



**rothoblass
WASP**



RAPID T-LIFT



**WÜRTH
Transportation anchor**

Other lifting systems on request

WÜRTH LIFTING SYSTEM

Minimum wood thickness: with planar lifting ≥ 120 mm, with frontal lifting ≥ 160 mm (with locking screw)

The transport anchoring screw is installed countersunk in the element by approx. 10 mm using bit insert AW40.

Note: The usage instructions of the respective manufacturer (e.g. check drill hole) must be observed before lifting the elements using lifting/turning systems.

Item no.	Designation	PU	UP
6206TRANSPORTANKER	Transportation anchor	2 pieces	2 pieces
6203SCHRAUBE12x100/60	Transportation anchor screw 12x100/60	50 pcs./pack	pack
6203SCHRAUBE12x120/100	Transportation anchor screw 12x120/100	50 pcs./pack	pack
6203SCHRAUBE12x160/145	Transportation anchor screw 12x160/145	50 pcs./pack	pack
6204BITEINSATZ	Bit insert AW40 mm	1 pieces	Piece
6204WÜRTH-BOHRUNGEN	Drill hole Würth lifting systems	1 pieces	Piece

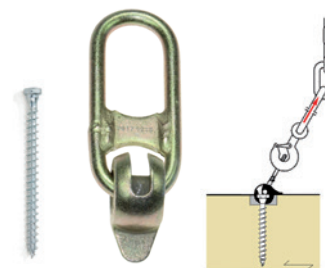

Fasteners

X-fix® C

X-fix® C is a two-piece, self-tightening wood-wood connector for compression and tension-proof connection of CLT ceilings and walls. X-fix® C is a wedge-shaped dovetail wood-wood connector. The X-fix® C wedge shape even clamps large-format ceiling panels or wall parts in a self-tightening, form-fitting way. The advantages of X-fix® C: Fast installation, form-fitting connection is ideal for visible surfaces, no panel tighteners required for ceiling connections, and thanks to the wedge shape, X-fix® C even clamps large-format ceiling panels together in a self-tightening way, no metal in the pure wood-wood connection.



Item no.	Designation	PU	UP
6209X-FIX	X-fix® C 96/130/90	1 pieces	Piece
6209X-FIX-BOHRUNGEN	Drill hole for X-fix (both sides)	1 pieces	Piece

Note: Only with CLT in conjunction with a tongue & groove connection possible

HECO-TOPIX® plus

Full-thread screw with cylinder head, ETA-19/0553 for a cross screw connection at the ceiling element joint creating a static ceiling section. Verification possible via best wood STATICS.

Item no.	Delivery form	PU	UP
6229ZK6/160	6 x 160 mm	100 pcs./pack	pack



Soundproofing

best wood BOUNDSPLITT

best wood BOUNDSPLITT is a chippings binder for manufacturing a flexibly bound chippings filling for improving the soundproofing of wooden ceilings.

best wood BOUNDSPLITT remains flexible after drying, and is therefore acoustically comparable with the best wood CHIPPINGS in the best wood HONEYCOMB. Filling heights of 30 to 120 mm can be realised. Approximately 0.3 kg of binder is needed with dry 5/8 chippings per m² and filling height of 10 mm. The drying time under optimum conditions and dry chippings is approx. 8 days for a filling height of 80 mm. The mixture of chippings binder and chippings can be applied with a screed pump.

best wood BOUNDSPLITT will keep for 12 months. The storage temperature must be no less than 5°C. The processing temperature is 5° C to 35° C.

More information about processing can be found in the technical data sheet at www.schneider-holz.com. Acoustically tested component structures with best wood BOUNDSPLITT can be found in the component database on our web site.

Transportation charges on request.



Item no.	Designation	PU	UP
6220BOUNDSPLITT	BoundSplitt canister	20 kg	kg
6220BOUNDSPLITTIBC	BoundSplitt IBC container	1000 kg	kg

best wood CHIPPINGS

best wood CHIPPINGS consist of a grain made from natural calcium carbonate, which is manufactured using state-of-the-art grinding and drying systems and sieving machines. It is used for putting into the best wood CLT BOX – CEILING FS and as ballast in best wood ceiling elements.



Item no.	Designation	PU	UP
6220SCHUETTUNG	best wood CHIPPINGS bag	25 kg/bag, 40 bags/pallet	Bag
6220SCHUETTUNGBIGBAG	best wood CHIPPINGS Big Bag	1000 kg/Big Bag on pallet	Big Bag

Delivery of best wood CHIPPINGS in loose form in silo vehicle by request.

best wood EASY FILL

best wood EASY FILL makes easy and quick filling of best wood CHIPPINGS in a predefined quantity into the CLT BOX – CEILING FS possible.

Item no.	Designation	PU	UP
6231EASYFILLKAUF	best wood EASY FILL for buying	1 piece	Piece
6231EASYFILLPFAND	best wood EASY FILL deposit	1 piece	Piece



best wood HONEYCOMB 30/60

HONEYCOMB is a honeycomb board made from cardboard which prevents the best wood CHIPPINGS from moving or shifting. Laying the chippings directly on the honeycomb provides a consistent layer thickness.

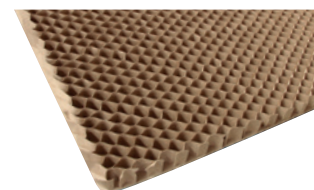

Item no.	Designation	PU	UP
6221WABE30	best wood HONEYCOMB 30	1.5 m ² /board, 30 boards/pallet	m ²
6221WABE60	best wood HONEYCOMB 60	1.5 m ² /board, 15 boards/pallet	m ²

Filling quantity of best wood CHIPPINGS in best wood HONEYCOMB 30/60: HONEYCOMB 30 approx. 42 kg/m² | HONEYCOMB 60 approx. 84 kg/m²

Fireproofing

Hilti CFS-S ACR fire protection sealing compound

Acrylate-based fire protection sealing compound for sealing element joints with fire protection requirements for the best wood CLT BOX - CEILING FS

Hilti CP 611A/CFS-IS fire protection sealing compound

Intumescent fire protection sealing compound for sealing individual cable entries and the Hilti cable sleeve CFS-SL GA in the best wood CLT BOX – CEILING FS



Advice and sale by HILTI

Hilti Germany
Hiltistraße 2
86916 Kaufering
Phone 0800-8885522
www.hilti.de

Hilti Austria Gesellschaft m.b.H.
Altmannsdorfer Straße 165
1230 Vienna
Phone 0800-818100
www.hilti.at

Hilti Schweiz AG
Soodstrasse 61
8134 Adliswil
Phone 0844-848485
www.hilti.ch

Example of element joints construction with fire resistance requirement up to F 60:

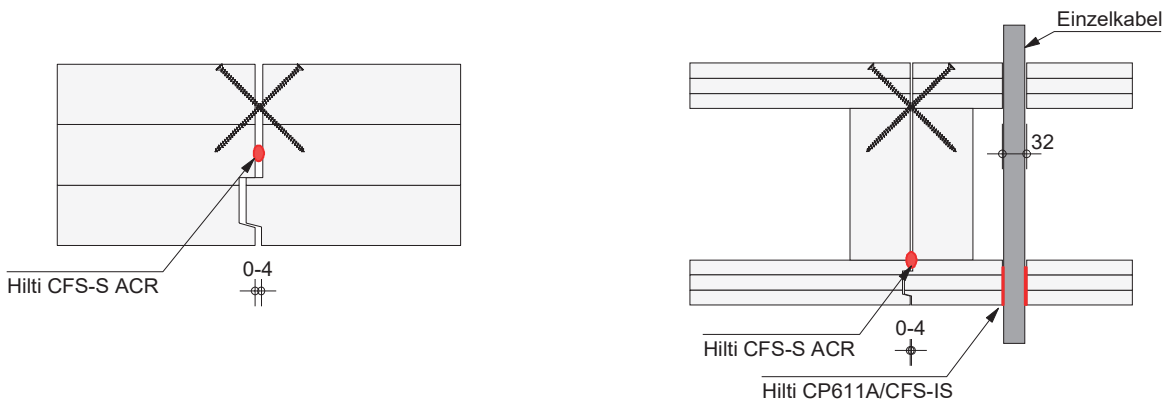

Example support with fire resistance requirement up to F 60:

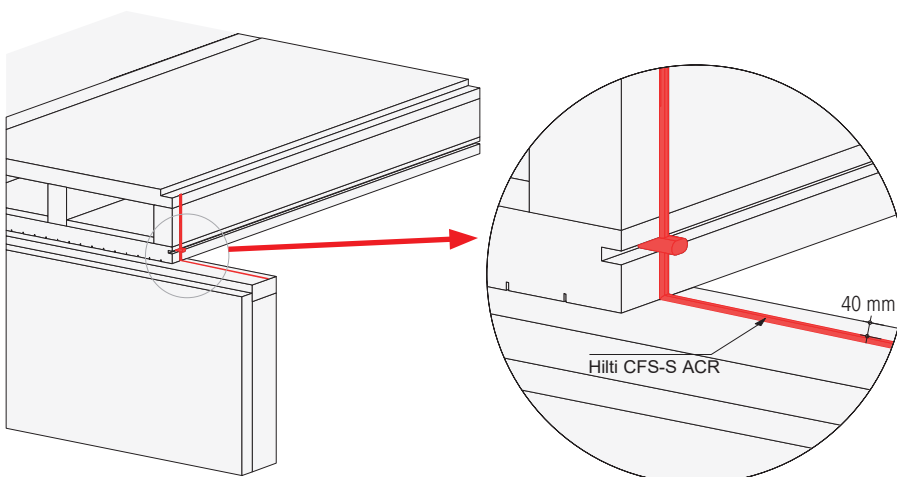

Other element joints constructions, leadthroughs through the element or installations with fire resistance requirements for CLT BOX can be found in ETA-21/0336 and for CLT in ETA-21/0568.

For the planning of the individual versions or details, please note the technical specifications with regard to fasteners and connection distances in ETA-21/0336 and ETA-21/0568.

Vapor barrier and airtight sealing membrane / Adhesive tapes

WETGUARD® 200 SA 390 or 1560 mm

Rain-proof and robust membrane that is self-adhesive over its entire surface for reliable moisture protection of wooden elements during transport, installation and construction time.

Field of application

Indoors and outdoors

Advantages

Fleece with non-slip coating and adhesive application over the entire surface. Transparent, robust and resistant to friction wear.

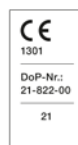

SIGA 



s _d value	3.5 m
Reaction to fire	E
Outdoor weather exposure	3 months
Watertight	W1
Temperature resistance	-40°C to +80°C

Item no.	Roll length	Roll width	Area	Roll weight
6233SIGAWETGUARD390	50 m	390 mm	19.6 m²/roll	6.2 kg
6233SIGAWETGUARD1560	50 m	1560 mm	78 m²/roll	24.6 kg

TESCON VANA

Multi-purpose adhesive tape with fleece back

Field of application

Can be used to form a secure and permanent seal on overlaps between foil and fleece membranes (vapor barriers and airtight sealing membranes, roof underlays and wall membranes) and joints between them. It is also suitable for sealing butt joints between wood-based material panels.

Advantages

Long-lasting sealed bonds, indoors and outdoors; with pliable fleece backing; can be torn off by hand; for airtight bonds in accordance with DIN 4108-7, SIA 180 and ÖNorm B8110-2; high initial adhesiveness: extremely high final adhesion; waterproof adhesive.



developed and produced
by pro clima

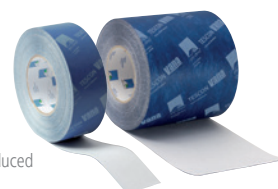

Backing	Special PP fleece
Separating layer	Siliconized paper
Temperature resistance	Long term -40 °C to +90 °C
Processing temperature	From -10 °C
Outdoor weather exposure	6 months

Item no.	Roll length	Roll width	Contents	KG / PU
6102TESCONVANA60	30 m	60 mm	10 rolls/carton	6 kg
			1 roll	0.6 kg
6102TESCONVANA150	30 m	150 mm	2 rolls	3 kg

best wood ADHESIVE TAPE

Professional adhesive tape, self-adhesive on one side

Field of application

For masking the element joints and penetrations of all elements that are coated with AQUA PROTECT. The ADHESIVE TAPE is also used for all masking work on the best wood SEALING LEVEL FOR WINDOW SILLS.

Advantages

Permanently sealed bonding; strong adhesion, UV stable and ageing resistant.



Backing	LDPEco film, white
Separating layer	Siliconized paper
Temperature resistance	-30 °C to + 100 °C
Processing temperature	+5 °C
Outdoor weather exposure	2 years UV-resistant

Item no.	Roll length	Roll width	Contents	KG / PU
6235KLEBEBAND60	30 m	60 mm	10 rolls/carton	8.5 kg
6235KLEBEBAND100	30 m	100 mm	6 rolls/carton	8.5 kg
6235KLEBEBAND180	30 m	180 mm	4 rolls/carton	10.0 kg

Lighting systems

incl. operating device

Description

Nowadays the solution in many areas consists of LEDs, whose efficiency is enhanced by intelligent light controls and innovative operating devices. The new, dimmable LED lighting systems for our ceiling and roof systems are high quality, and impress with their timeless design. This guarantees that you will realize long-lasting lighting ideas. Suitable holes drilled in the factory make installation child's play, the lamps just need to be cabled and clipped in place.

RECESS MOUNTED LIGHTS

LED 170 round

The lighting systems are coordinated with our best wood GLULAM and CLT ceilings and CLT BOX, and can be supplied ready-drilled with the relevant holes at an additional cost.

Even light distribution over the entire light outlet surface.
Dimmable with a trailing edge dimmer.

The lights are only suitable for indoors and for connecting to safety extra-low voltage.



Wattage [Watt]	11
Connection voltage [Volts]	230
Lamp	SMD LED
Light colour	Warm white
Colour temperature [Kelvin]	Approx. 3000 K
Luminous flux [Lumen]	840 lm
Colour rendering	Ra > 80
Material	Aluminum/PMMA diffusor disk
Operating device (transformer)	Included (packaged separately)
Dimmable	yes
Degree of protection	IP20
Installation depth	55 mm with best wood ceiling systems
External diameter	170 mm

Item no.	Designation	PU	UP
6222-170RW	LED 170 round white	1 pc.	Piece
6222-170RTM	LED 170 round matt titanium	1 pc.	Piece
6222-170R-BOHRUNGEN	Drill holes for LED 170	1 pc.	Piece

LED 90 spot

The lighting systems are coordinated with our best wood GLULAM and CLT ceilings and CLT BOX, and can be supplied ready-drilled with the relevant holes at an additional cost.

The reflector is made from real glass, and the lighting system is dimmable with a trailing edge dimmer.

The lights are only suitable for indoors and for connecting to safety extra-low voltage.

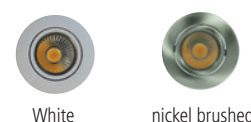

Wattage [Watt]	8
Connection voltage [Volts]	230
Lamp	COB LED
Light colour	Warm white
Colour temperature [Kelvin]	Approx. 3000 K
Luminous flux [Lumen]	850 lm
Colour rendering	Ra > 90
Material	Diecast aluminum/real glass reflector
Radiation angle, swivelling	38 degrees
Operating device (transformer)	Included (packed with spot)
Dimmable	yes
Degree of protection	IP40
Installation depth	75 mm with best wood ceiling systems
External diameter	90 mm

Item no.	Designation	PU	UP
6222-90SPOTW	LED 90 Spot white	1 pc.	Piece
6222-90SPOTN	LED 90 Spot nickel brushed	1 pc.	Piece
6222-90SPOT-BOHRUNGEN	Drill holes for LED 90 Spot	1 pc.	Piece

LED 90 FireSpot

Even demanding lighting tasks can be solved without problems with the LED 90 FireSpot, thanks to the high light output. Installation in the BS3700TC fire protection box fulfils the requirements for fire protection shielding in a best wood ceiling element with a fire resistance duration of 60 minutes.

The LED 90 FireSpot can only be purchased in combination with a BS3700TC fire protection box.

The lighting systems are coordinated with our best wood GLULAM, CLT and CLT BOX ceiling elements, and can be supplied ready-drilled with the relevant holes at an additional cost.



White



nickel brushed

Item no.	Designation	PU	UP
6222-90FSPOTW-BS3700TC	LED 90 FireSpot, white, including BS3700TC fire protection box	1 pc.	Piece
6222-90FSPOTN-BS3700TC	LED 90 FireSpot, nickel brushed, including BS3700TC fire protection box	1 pc.	Piece
6222-90FSPOT-BOHRUNGEN	Drill holes for LED 90 FireSpot	1 pc.	Piece

Wattage [Watt]	7
Connection voltage [Volts]	230
Lamp	LED
Light colour	Warm white
Colour temperature [Kelvin]	3000 K
Luminous flux [Lumen]	650 lm
Colour rendering	Ra > 80
Material	Aluminum
Operating device (transformer) incl.	
Dimmable	yes
Degree of protection	IP44
Installation depth	with fire protection box 62 mm
External diameter	90 mm

BS3500TC fire protection box

The BS3700TC is a fire protection box which has been developed for installation in solid wood ceilings and walls, for fire protection shielding up to EI60.

Due to the newly developed and patented f-tronic® TC fastening system with claw, the box can be quickly and easily attached in the solid wood. The intumescent material seals the opening in the event of a fire.



■ ■ SURFACE MOUNTED LIGHTS

The surface mounted lighting systems are tailored to our best wood GLULAM, CLT and CLT BOX ceilings, and can be directly attached to the ceiling. Even light distribution over the entire light outlet surface and the lights are dimmable with a trailing edge dimmer. The lights are only suitable for indoors and for connecting to safety extra-low voltage.

- Very low installation height of just 15 mm
- Elegant design
- Different colour temperatures possible
- Integrated transformer

LED 165 | 217 Standard

Available in colour temperatures of 3000 or 4000 Kelvin.

Item no.	Designation	PU	UP
6226-165STW3K	LED 165 Standard round white 3000 K	1 pc.	Piece
6226-165STW4K	LED 165 Standard round white 4000 K	1 pc.	Piece
6226-217STW3K	LED 217 Standard round white 3000 K	1 pc.	Piece
6226-217STW4K	LED 217 Standard round white 4000 K	1 pc.	Piece
6226-165STN3K	LED 165 Standard round nickel brushed 3000 K	1 pc.	Piece
6226-165STN4K	LED 165 Standard round nickel brushed 4000 K	1 pc.	Piece
6226-217STN3K	LED 217 Standard round nickel brushed 3000 K	1 pc.	Piece
6226-217STN4K	LED 217 Standard round nickel brushed 4000 K	1 pc.	Piece



Wattage [Watt]	12 (LED 165) or 18 (LED 217)
Connection voltage [Volts]	230
Lamp	SMD LED
Light colour	Warm white - neutral white
Colour temperature [Kelvin]	3000 or 4000 K
Luminous flux [Lumen]	with 3000 K: 1000 or 1550 with 4000 K: 1100 or 1600
Colour rendering	Ra > 80
Material	Aluminum/plastic
Operating device (transformer)	integrated
Dimmable	yes
Degree of protection	IP20
Installation height	15 mm
External diameter	165 mm or 217 mm

LED 165 | 217 Premium

The colour temperature with all Premium models is adjustable between 3000, 4000 or 6500 Kelvin.

Item no.	Designation	PU	UP
6226-165PRW	LED 165 Premium round white	1 pc.	Piece
6226-217PRW	LED 217 Premium round white	1 pc.	Piece
6226-165PRN	LED 165 Premium round nickel brushed	1 pc.	Piece
6226-217PRN	LED 217 Premium round nickel brushed	1 pc.	Piece



Wattage [Watt]	12 (LED 165) or 18 (LED 217)
Connection voltage [Volts]	230
Lamp	SMD LED
Light colour	Warm white - neutral white
Colour temperature [Kelvin]	3000, 4000, 6500 K (adjustable)
Luminous flux [Lumen]	1000 or 1700 lm
Colour rendering	Ra > 80
Material	Aluminum/plastic
Operating device (transformer)	integrated
Dimmable	yes
Degree of protection	IP20
Installation height	15 mm
External diameter	165 mm or 217 mm

Colour finishing from the factory

COLOUR FINISHING + UV PROTECTION

Description

Building elements with mineral paint or the colourless UV-protect paint applied, for internal application, are delivered ready picked to the construction site. The colours impress with their appealing look and longevity. All best wood glazes retain the diffusion-open characteristics of the wood and provide a good room and living climate. The natureplus-certified coated elements are available in a sanded look.

Characteristics

Water-based
Without solvents and plasticisers
Natureplus certified
Diffusion-open
Sustainable
For a good indoor and living climate

Remarks

The representations of colours and products may differ from the actual colouring. Wood is a natural product. Colour deviations due to differences in structure and grain are possible and typical.

Further colours available by request.

Colour variants



UV-protect

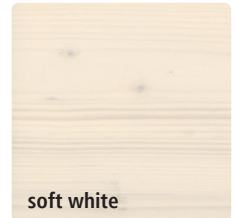

soft white

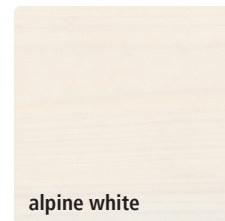

alpine white

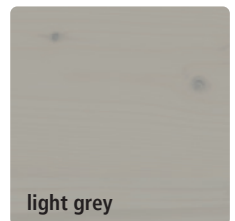

light grey

Accessories for ceiling finishing

Soft wax

Soft wax for surface correction of the best wood painted ceilings for repairing scratches, cracks, holes and dents in the surface area. Coordinated with the best wood colour variants.

Item no.	Designation	PU	UP
6213WACHSF	Soft wax colourless	2 pcs./pack	pack
6213WACHSUV	Soft wax UV-protect	2 pcs./pack	pack
6213WACHSZW	Soft wax soft white	2 pcs./pack	pack
6213WACHSEW	Soft wax alpine white	2 pcs./pack	pack
6213WACHSLG	Soft wax light grey	2 pcs./pack	pack

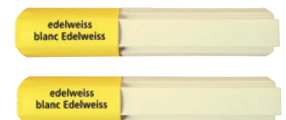

Soft wax spatula

Soft wax spatula for applying and modelling soft wax during surface correction.

Item no.	Designation	PU	UP
6214WACHSSPACHTEL	Soft wax spatula	1 pieces	Piece



best wood CEILING TAPE

Ceiling tape for masking all best wood painted ceilings. The ceiling tape is available with a width of 50 mm, and prevents adhesive residue on the varnished surfaces. 50 running metres per roll.

Item no.	Designation	PU	UP
6210DECKENTAPE	best wood ceiling tape	50 rmt/roll	Roll

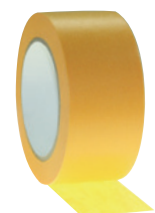

Colours for processing at home

Please note the special processing guidelines for colour finishing!
read more at www.schneider-holz.com

TIMBERBASE

Primer for visible wooden elements indoors.

TIMBERBASE has been developed as an environmentally friendly industrial product for priming visible wooden elements indoors, such as cross laminated timber (CLT) or GLULAM (BSH), which are subsequently going to be treated with TIMBERCOLOR or UV-protect.



Item no.	Designation	PU	UP
6228TB1,0	TIMBERBASE	1.0 l	Litre
6228TB2,5	TIMBERBASE	2.5 l	Litre
6228TB5,0	TIMBERBASE	5.0 l	Litre
6228TB10,0	TIMBERBASE	10.0 l	Litre

TIMBERCOLOR

Timbercolor is used for finishing the ceiling elements in the interior.

Specially developed for materials such as cross laminated timber (CLT and CLT BOX) and glued laminated timber (GLULAM), Timbercolor provides an appealing and transparent finish which emphasizes the natural charm of the wood.

New improved formula:

Robust: The newly revised and improved TIMBERCOLOR ensures that the colour is durable and withstands the everyday requirements.

Easy care: TIMBERCOLOR can be wiped over and cleaned effortlessly, whereby the colours remain clean and appealing.

Application: For corrections to our ceiling elements and, thanks to the new formula, also for heavily used surfaces such as columns, pillars and purlins.

TIMBERBASE must be applied as the primer.

NEW!
Improved formula!



Item no.	Designation	PU	UP
6228TCUV1,0	TIMBERCOLOR - UV-protect	1.0 l	Litre
6228TCUV2,5	TIMBERCOLOR - UV-protect	2.5 l	Litre
6228TCUV5,0	TIMBERCOLOR - UV-protect	5.0 l	Litre
6228TCUV10,0	TIMBERCOLOR - UV-protect	10.0 l	Litre
6228TCZW1,0	TIMBERCOLOR - soft white	1.0 l	Litre
6228TCUZW2,5	TIMBERCOLOR - soft white	2.5 l	Litre
6228TCTZW5,0	TIMBERCOLOR - soft white	5.0 l	Litre
6228TCTZW10,0	TIMBERCOLOR - soft white	10.0 l	Litre
6228TCEW1,0	TIMBERCOLOR - alpine white	1.0 l	Litre
6228TCUEW2,5	TIMBERCOLOR - alpine white	2.5 l	Litre
6228TCEW5,0	TIMBERCOLOR - alpine white	5.0 l	Litre
6228TCEW10,0	TIMBERCOLOR - alpine white	10.0 l	Litre
6228TCLG1,0	TIMBERCOLOR - light grey	1.0 l	Litre
6228TCULG2,5	TIMBERCOLOR - light grey	2.5 l	Litre
6228TCLG5,0	TIMBERCOLOR - light grey	5.0 l	Litre
6228TCLG10,0	TIMBERCOLOR - light grey	10.0 l	Litre



MESSKIRCH



EBERHARDZELL



MÄRSTETTEN

Eberhardzell site

best wood SCHNEIDER GmbH
Kappel 28 | D-88436 Eberhardzell
Phone +49 (0)7355 9320-0
Fax +49 (0)7355 9320-300

Subsidiary Meßkirch

best wood SCHNEIDER GmbH
Industriepark 16 | D-88605 Meßkirch
Phone +49 (0)7355 9320-8000
Fax +49 (0)7355 9320-300

Subsidiary Switzerland

best wood SCHNEIDER GmbH
Weinfelderstrasse 29A | CH-8560 Märstetten
Phone +41 (0)71 918 79 79
Fax +41 (0)71 918 79 78

Good for nature, good for us all. Tested & certified.

The Schneider company group is a regionally operating family-run company with headquarter in Eberhardzell. At the highest technical level, we produce all supporting wood components and wood fiber insulation boards for modern wood and passive house construction and pellets for ecological heating with more than 600 employees.

From round wood to finished product including energy requirement, we implement everything in a closed raw material cycle in our production facilities in Southern Germany. best wood Schneider realises energy-efficient production in accordance with DIN ISO 50001 when doing this. The wood raw material is utilised 100 % to the last chip.

